

Nuts

OTHER NUTS

DIN 982.8 PREVAILING TORQUE TYPE HEX. NUT WHITE ZINC PLATED

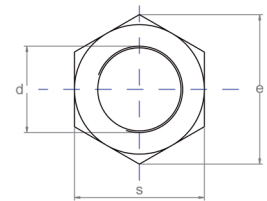
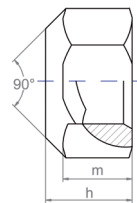
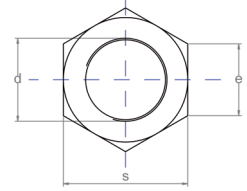
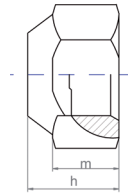
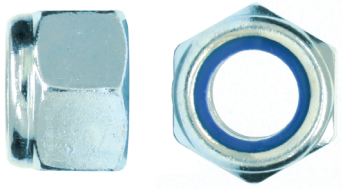

				DIN 982.8
METRIC	PITCH	h	s	PREVAILING TORQUE TYPE HEX. NUT WHITE ZINC PLATED
M-4	0,6	4,8	7	•
M-5	0,8	6,3	8	•
M-6	1	8	10	•
M-8	1,25	9,5	13	•
M-10	1,5	11,5	17	•
M-12	1,75	14	19	•
M-14	2	16	22	•
M-16	2	18	24	•
M-18	2,5	20	27	•
M-20	2,5	22	30	•