

HIGH-STRENGTH STRUCTURAL WASHER

DIN 6916-HV WHITE ZINC PLATED

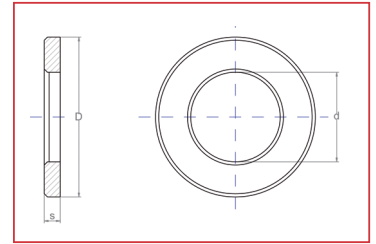
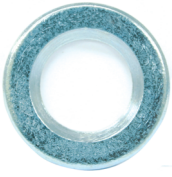

METRIC	PITCH	m	s	d	D	s	DIN 6916 - HV WHITE ZINC PLATED
M-12	1,75	10	22	13	24	3	•
M-14							
M-16	2	13	27	17	30	4	•
M-18							
M-20	2,5	16	32	21	36	4	•
M-22	2,5	19	36	23	40	4	•
M-24	3	19	41	25	44	4	•
M-27	3	22	46	28	50	5	•
M-30	3,5	24	50	31	56	6	•
M-33							
M-36	4	29	60	37	66	6	•